



# EMERALD SUN DECK PLAN & SHIP STATISTICS



CABIN CATEGORIES		
<b>Horizon Deck</b>		
<b>CAT SA</b>	Owner's One-Bedroom Suite	315ft² (29.3m²)
<b>CAT S</b>	Grand Balcony Suite*	210ft² (19.5m²)
<b>CAT A</b>	Emerald Panorama Balcony Suite	180ft² (16.7m²)
<b>Vista Deck</b>		
<b>CAT B</b>	Emerald Panorama Balcony Suite	180ft² (16.7m²)
<b>CAT C</b>	Emerald Panorama Balcony Suite	180ft² (16.7m²)
<b>Riviera Deck</b>		
<b>CAT D</b>	Emerald Stateroom	162ft² (15m²)
<b>CAT E</b>	Emerald Stateroom	162ft² (15m²)
<b>CAT ES</b>	Emerald Single Stateroom	117ft² (10.9m²)

- 1 Sun Deck with Deck Chairs^
- 2 Navigation Bridge
- 3 Sky Barbecue
- 4 Golf Putting Green
- 5 Games Area
- 6 Retractable Glass Roof
- 7 Walking Track
- 8 Daytime Pool & Bar/Evening Cinema
- 9 The Terrace
- 10 Horizon Bar & Lounge
- 11 Lift
- 12 Reception
- 13 Wellness Area
- 14 Fitness Area
- 15 Reflections Restaurant
- 16 Hairdresser

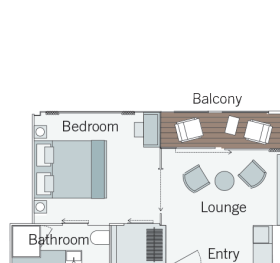

Owner's One-Bedroom Suite  
315ft² (29.3m²)  
**CAT SA**

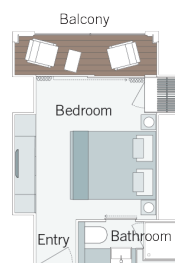

Grand Balcony Suite  
210ft² (19.5m²)  
**CAT S**

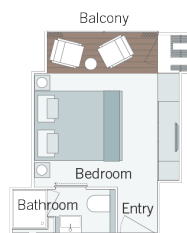

Emerald Panorama Balcony Suite  
180ft² (16.7m²)  
**CAT A CAT B CAT C**



Emerald Stateroom  
162ft² (15m²)  
**CAT D CAT E**

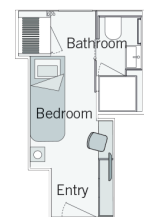

Emerald Single Stateroom  
117ft² (10.9m²)  
**CAT ES**